

Z-250-S translating screw 250 kN

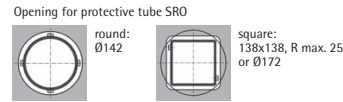

1) Fitting height for 0-stroke, with Tr 80x16 screw

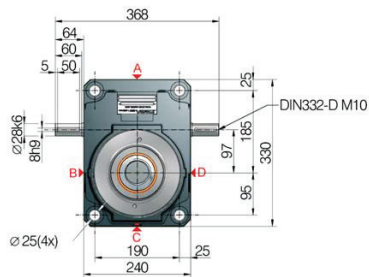
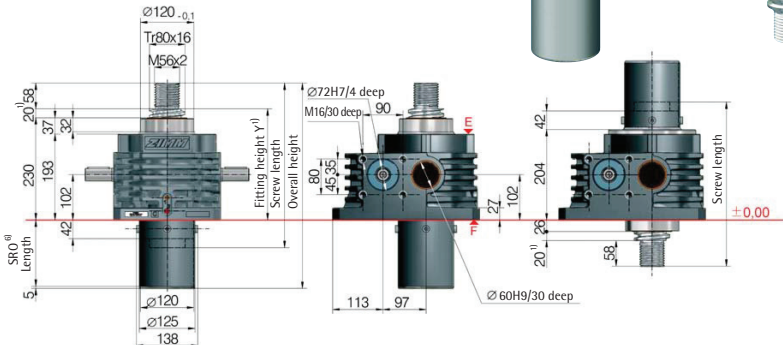
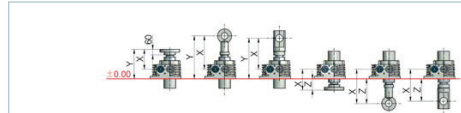

All dimensions in mm							
Bellocks FB	X/Y	X/Y	X/Y	X/Z	X/Z	X/Z	X/Z
without bellows FB	208/310	348/450	328/430	208/106	348/246	328/226	
Z-250-FB-390	276/378	441/543	396/498	276/174	441/339	396/294	
Z-250-FB-600	258/360	423/525	378/480	258/156	423/321	378/276	
Z-250-FB-1000	316/418	481/583	436/538	316/214	481/379	436/334	
Z-250-FB-1500	366/468	531/633	486/588	366/264	531/429	486/384	

\*with bellows fixing ring Z-250-FBR

2) Protective tube length SRO with Tr 80x16 screw

only screw	with escape protection AS	with rotation protection VS	with VS and limit switch set ES
○ Ø125	○ Ø125	□ 120x120	□ 120x120
92+stroke	122+stroke	122+stroke	150+stroke

Standard ratios

Type	Version	Speed	Standard screw <sup>2)</sup>	i	Stroke per drive shaft rotation <sup>3)</sup>
Z-250-SN	Translating	Normal	Tr 80x16	10.66:1	1.5 mm
Z-250-SL	screw	Low speed		32:1	0.5 mm
Z-250-RN	Rotating	Normal	Tr 80x16	10.66:1	1.5 mm
Z-250-RL	screw	Low speed		32:1	0.5 mm

Screw jack mounting

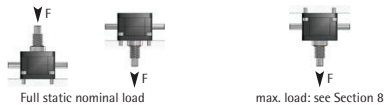

Duty cycle thermal limit, for S+R

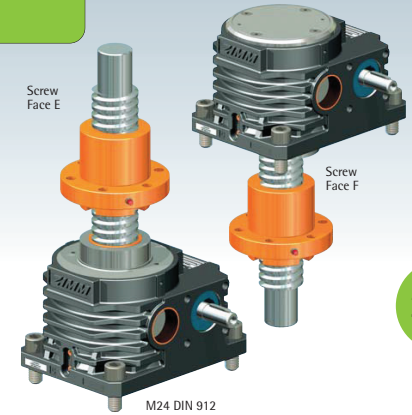
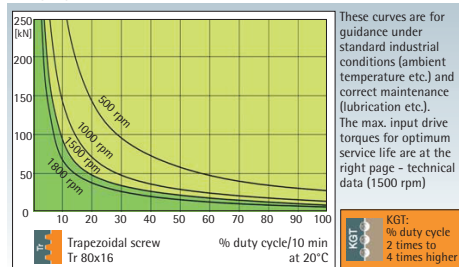

Z-250-R rotating screw 250 kN

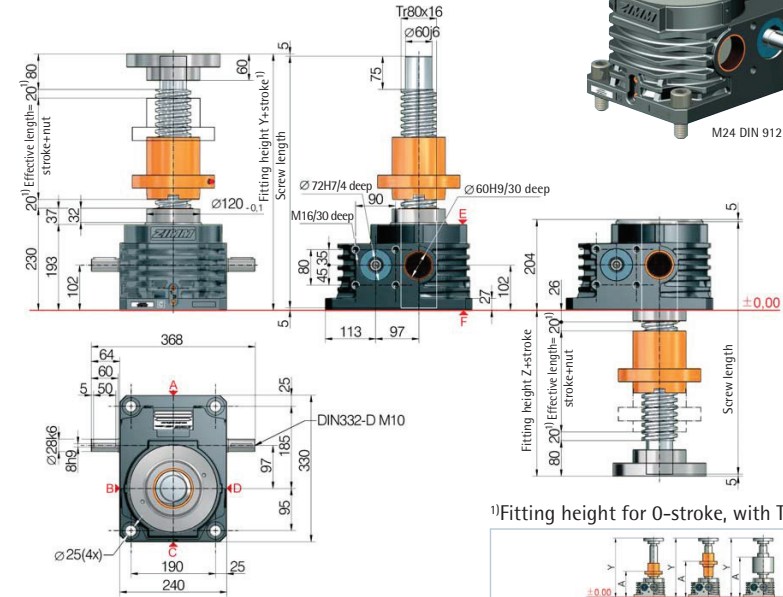

1) Fitting height for 0-stroke, with Tr 80x16 screw

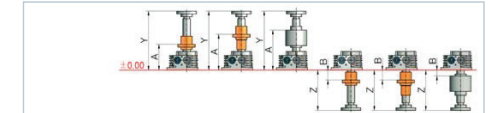

All dimensions in mm							
Bellocks FB	Y/A	Y/A	Y/A	Z/B	Z/B	Z/B	Z/B
without bellows FB	490/305	600/415	574/434	286/131	396/131	370/86	
2x Z-250-FB-390	608/373	712/477	692/502	404/199	514/199	488/154	
2x Z-250-FB-600	572/355	676/459	656/484	368/181	478/181	452/136	
2x Z-250-FB-1000	688/413	792/517	772/542	484/239	594/239	568/194	
2x Z-250-FB-1500	788/463	892/567	872/592	584/289	694/289	668/244	

Detailed instructions for determining the length can be found in Section 8

250 kN

Technical data series Z-250-S / Z-250-R

max. compressive/tensile force, static	- 250 kN (25 t)
max. compressive/tensile force, dynamic	- see duty cycle curves
Nominal speed	- 1500 rpm
max. drive shaft speed	- 1800 rpm
Screw size standard	- Tr 80x16 <sup>2)</sup>
Gear ratio	- 10.66:1 (N) / 32:1 (L)
Housing material	- GGG-50, corrosion-resistant
Worm shaft	- steel, case-hardened, ground
Weight of screw jack body	- 59 kg
Weight of screw/m	- 32 kg
Gearbox lubrication	- synthetic gear oil
Screw lubrication	- grease lubrication
Gearbox operating temperature	- max. 60°C, higher on request
Moment of inertia	- N: 53.8 kg cm <sup>2</sup> / L: 22.0 kg cm <sup>2</sup>
Input torque (at 1500 rpm)	- max. 152 Nm (N) / max. 41.4 Nm (L)
Drive-through torque	- max. 770 Nm

Drive torque M <sub>0</sub> (Nm)	- F (kN) x 0.94 <sup>3)</sup> + M <sub>0</sub> (N-normal)
	- F (kN) x 0.37 <sup>3)</sup> + M <sub>0</sub> (L-low speed)
Breakaway torque	- Drive torque M <sub>0</sub> x 1.5
Idling torque <sup>4)</sup> M <sub>0</sub> (Nm)	- 2.64 (N-normal) / 1.94 (L-low speed)

Between gearbox and nut or nut and end of thread, provide for a safety distance of (minimum) 20 mm!  
See Section 7 for the checklist.

**Important information**

- 1) - extension if a bellows or spiral spring is fitted: see the table or Section 8
- 2) - Tr 80x16 is standard, also available: double-pitch, stainless steel, left-handed, increased screw Tr 100x16 (only for the R version)
- 3) - factor includes efficiency, ratio and 30% safety
- 4) - at 20°C, can be higher when new
- 5) - for a 16 mm screw pitch