

Z-250-S translating screw 250 kN

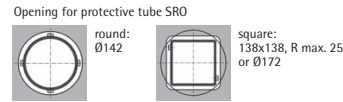

1) Fitting height for 0-stroke, with Tr 80x16 screw

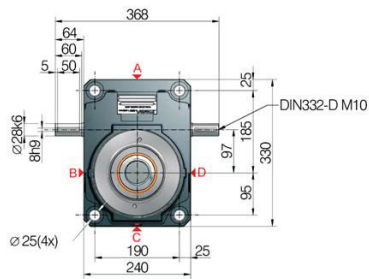
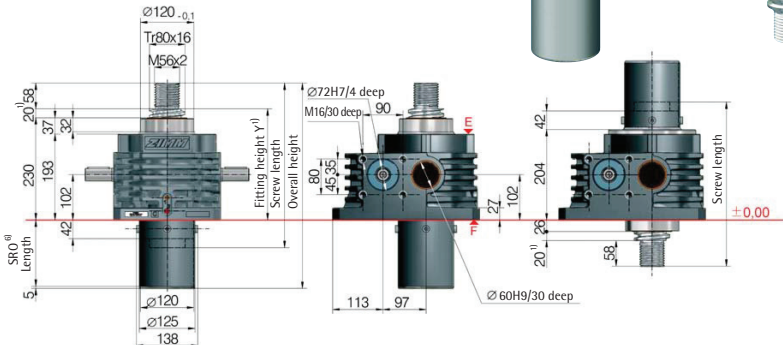
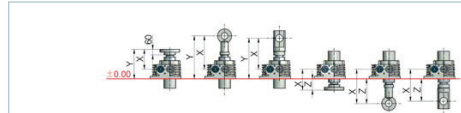

| All dimensions in mm | | | | | | | |
|----------------------|---------|---------|---------|---------|---------|---------|---------|
| Bellocks FB | X/Y | X/Y | X/Y | X/Z | X/Z | X/Z | X/Z |
| without bellows FB | 208/310 | 348/450 | 328/430 | 208/106 | 348/246 | 328/226 | 328/226 |
| Z-250-FB-390 | 276/378 | 441/543 | 396/498 | 276/174 | 441/339 | 396/294 | 396/294 |
| Z-250-FB-600 | 258/360 | 423/525 | 378/480 | 258/156 | 423/321 | 378/276 | 378/276 |
| Z-250-FB-1000 | 316/418 | 481/583 | 436/538 | 316/214 | 481/379 | 436/334 | 436/334 |
| Z-250-FB-1500 | 366/468 | 531/633 | 486/588 | 366/264 | 531/429 | 486/384 | 486/384 |

*with bellows fixing ring Z-250-FBR

2) Protective tube length SRO with Tr 80x16 screw

| only screw | with escape protection AS | with rotation protection VS | with VS and limit switch set ES |
|------------|---------------------------|-----------------------------|---------------------------------|
| ○ Ø125 | ○ Ø125 | □ 120x120 | □ 120x120 |
| 92+stroke | 122+stroke | 122+stroke | 150+stroke |

Standard ratios

| Type | Version | Speed | Standard screw ²⁾ | i | Stroke per drive shaft rotation ³⁾ |
|----------|-------------|-----------|------------------------------|---------|---|
| Z-250-SN | Translating | Normal | Tr 80x16 | 10.66:1 | 1.5 mm |
| Z-250-SL | screw | Low speed | | 32:1 | 0.5 mm |
| Z-250-RN | Rotating | Normal | Tr 80x16 | 10.66:1 | 1.5 mm |
| Z-250-RL | screw | Low speed | | 32:1 | 0.5 mm |

Screw jack mounting

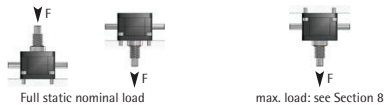

Duty cycle thermal limit, for S+R

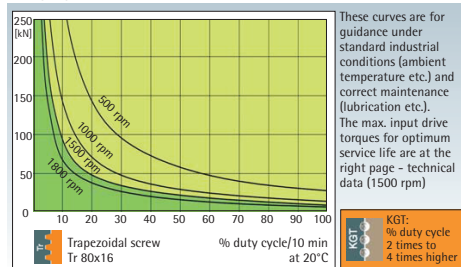

KTG: % duty cycle 2 times to 4 times higher

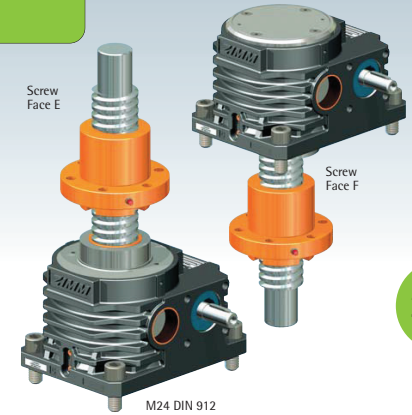

Z-250-R rotating screw 250 kN

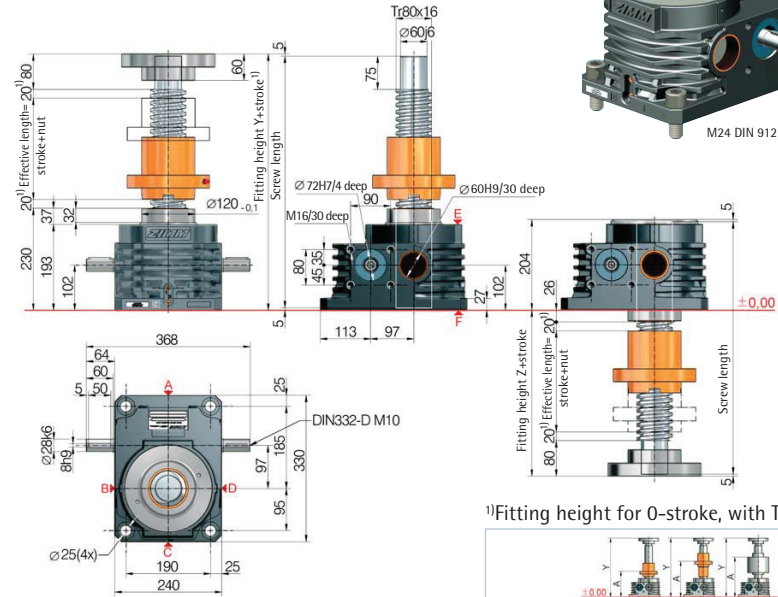

1) Fitting height for 0-stroke, with Tr 80x16 screw

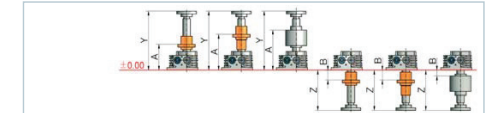

| All dimensions in mm | | | | | | | |
|----------------------|---------|---------|---------|---------|---------|---------|---------|
| Bellocks FB | Y/A | Y/A | Y/A | Z/B | Z/B | Z/B | Z/B |
| without bellows FB | 490/305 | 600/415 | 574/434 | 286/131 | 396/131 | 370/86 | 370/86 |
| 2x Z-250-FB-390 | 608/373 | 712/477 | 692/502 | 404/199 | 514/199 | 488/154 | 488/154 |
| 2x Z-250-FB-600 | 572/355 | 676/459 | 656/484 | 368/181 | 478/181 | 452/136 | 452/136 |
| 2x Z-250-FB-1000 | 688/413 | 792/517 | 772/542 | 484/239 | 594/239 | 568/194 | 568/194 |
| 2x Z-250-FB-1500 | 788/463 | 892/567 | 872/592 | 584/289 | 694/289 | 668/244 | 668/244 |

Detailed instructions for determining the length can be found in Section 8

250 kN

Technical data series Z-250-S / Z-250-R

max. compressive/tensile force, static - 250 kN (25 t)
 max. compressive/tensile force, dynamic - see duty cycle curves
 Nominal speed - 1500 rpm
 max. drive shaft speed - 1800 rpm
 Screw size standard - Tr 80x16²⁾
 Gear ratio - 10.66:1 (N) / 32:1 (L)
 Housing material - GGG-50, corrosion-resistant
 Worm shaft - steel, case-hardened, ground
 Weight of screw jack body - 59 kg
 Weight of screw/m - 32 kg
 Gearbox lubrication - synthetic gear oil
 Gearbox operating temperature - grease lubrication
 Moment of inertia - max. 60°C, higher on request
 Input torque (at 1500 rpm) - N: 53.8 kg cm² / L: 22.0 kg cm²
 Drive-through torque - max. 152 Nm (N) / max. 41.4 Nm (L)
 max. 770 Nm

Drive torque M₀ (Nm) - F (kN) x 0.94³⁾ + M₀ (N-normal)
 - F (kN) x 0.37³⁾ + M₀ (L-low speed)
 Breakaway torque - Drive torque M₀ x 1.5
 Idling torque⁴⁾ M₀ (Nm) - 2.64 (N-normal) / 1.94 (L-low speed)
 Between gearbox and nut or nut and end of thread, provide for a safety distance of (minimum) 20 mm!
 See Section 7 for the checklist.
Important information
 1) - extension if a bellows or spiral spring is fitted: see the table or Section 8
 2) - Tr 80x16 is standard, also available: double-pitch, stainless steel, left-handed, increased screw Tr 100x16 (only for the R version)
 3) - factor includes efficiency, ratio and 30% safety
 4) - at 20°C, can be higher when new
 5) - for a 16 mm screw pitch